

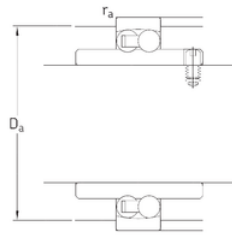

BEARING DRIVESHAFT, INC.

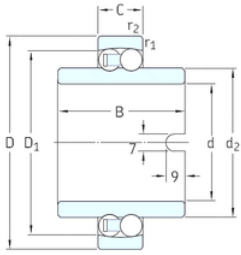

25 mm x 52 mm x 44 mm SKF 11205ETN9 self aligning ball bearings

Bearing No. 11205ETN9

11205ETN9 Bearing 2D drawings and 3D CAD models

Size	25x52x44 mm
Bore Diameter	25 mm
Outer Diameter	52 mm
Width	44 mm
d	25 mm
D	52 mm
B	44 mm
C	15 mm
d2	33,3 mm
r1 min.	1 mm
r2 min.	1 mm
D1	45,6 mm
Da max.	46,4 mm
ra max.	1 mm
Weight	0,22 Kg
Basic dynamic load rating (C)	14,3 kN
Basic static load rating (C0)	4 kN
Fatigue load limit (Pu)	0,21
Limiting speed	8000 r/min
Calculation factor (e)	0,28
Calculation factor (kr)	0,04
Calculation factor (Y0)	2,5
Calculation factor (Y1)	2,2