

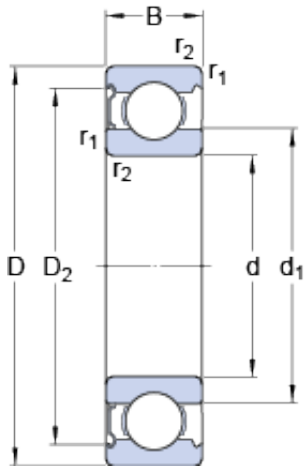

BEARING DRIVESHAFT, INC.



95 mm x 145 mm x 24 mm SKF 6019-Z deep groove ball bearings

Bearing No. 6019-Z

6019-Z Bearing 2D drawings and 3D CAD models

Size	145x95x24 mm
Bore Diameter	145 mm
Outer Diameter	95 mm
Width	24 mm
d	95 mm
D	145 mm
B	24 mm
d ₁	111.4 mm
D ₂	133.3 mm
r _{1,2} - min.	1.5 mm
d _a - min.	102 mm
d _a - max.	111 mm
D _a - max.	138 mm
r _a - max.	1.5 mm
Basic dynamic load rating - C	63.7 kN
Basic static load rating - C ₀	54 kN
Fatigue load limit - P _u	2.1 kN
Reference speed	9500 r/min
Limiting speed	6000 r/min
Calculation factor - k _r	0.025
Calculation factor - f ₀	15.8
Category	Single Row Ball Bearings
Inventory	0.0
Manufacturer Name	SKF



BEARING DRIVESHAFT, INC.

Minimum Buy Quantity	N/A
Weight / Kilogram	1.29
Product Group	B00308
Enclosure	1 Metal Shield
Precision Class	ABEC 1 ISO P0
Maximum Capacity / Filling Slot	No
Rolling Element	Ball Bearing
Snap Ring	No
Internal Special Features	No
Cage Material	Steel
Internal Clearance	C0-Medium
Inch - Metric	Metric
Long Description	95MM Bore; 145MM Outside Diameter; 24MM Outer Race Diameter; 1 Metal Shield; Ball Bearing; ABEC 1 ISO P0; No Filling Slot; No Snap Ring; No Internal Special Features
Category	Single Row Ball Bearing
UNSPSC	31171504
Harmonized Tariff Code	8482.10.50.68
Noun	Bearing
Keyword String	Ball
Manufacturer URL	http://www.skf.com
Manufacturer Item Number	6019-Z
Weight / LBS	2.83
Bore	3.74 Inch 95 Millimeter
Outside Diameter	5.709 Inch 145 Millimeter
Outer Race Width	0.945 Inch 24 Millimeter
d ₁	111.4 mm
D ₂	133.3 mm
r _{1,2} min.	1.5 mm



BEARING DRIVESHAFT, INC.

d_a min.	102 mm
d_a max.	111 mm
D_a max.	138 mm
r_a max.	1.5 mm
Basic dynamic load rating C	63.7 kN
Basic static load rating C_0	54 kN
Fatigue load limit P_u	2.08 kN
Calculation factor k_r	0.025
Calculation factor f_0	15.8
Mass bearing	1.26 kg