

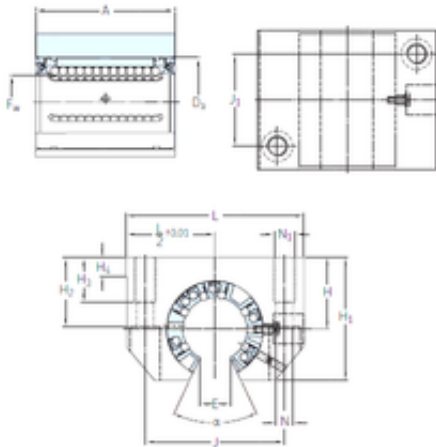

BEARING DRIVESHAFT, INC.

SKF LUNF 20 linear bearings



Bearing No. LUNF 20

Bore Diameter	20 mm
Fw	20 mm
H4	7,5 mm
H3	18 mm
Da	32 mm
Angle ()	60 °
A	45 mm
H	25 mm
H1	42 mm
H2	24 mm
J	45 mm
L	60 mm
N	6,6 mm
J1	32 mm
Thread (E)	10,8
Thread (N1)	M8
Weight	0,215 Kg
Basic dynamic load rating (C)	2 kN

LUNF 20 Bearing 2D drawings and 3D CAD models