

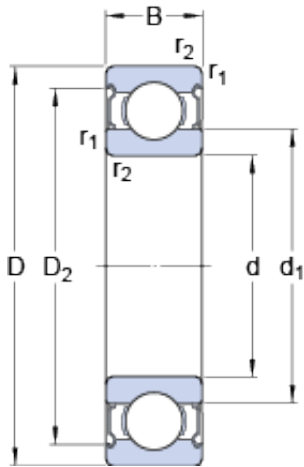

BEARING DRIVESHAFT, INC.



17 mm x 35 mm x 8 mm SKF 16003-2Z deep groove ball bearings

Bearing No. 16003-2Z

16003-2Z Bearing 2D drawings and 3D CAD models

Size	35x17x8 mm
Bore Diameter	35 mm
Outer Diameter	17 mm
Width	8 mm
d	17 mm
D	35 mm
B	8 mm
d ₁	23 mm
D ₂	31.2 mm
r _{1,2} - min.	0.3 mm
d _a - min.	19 mm
d _a - max.	22.6 mm
D _a - max.	33 mm
r _a - max.	0.3 mm
Basic dynamic load rating - C	6.4 kN
Basic static load rating - C ₀	3.2 kN
Fatigue load limit - P _u	0.137 kN
Reference speed	45000 r/min
Limiting speed	22000 r/min
Calculation factor - k _r	0.02
Calculation factor - f ₀	14
Category	Single Row Ball Bearings
Inventory	0.0
Manufacturer Name	SKF



BEARING DRIVESHAFT, INC.

Minimum Buy Quantity	N/A
Weight / Kilogram	0.036
Product Group	B00308
Enclosure	2 Metal Shields
Precision Class	ABEC 1 ISO P0
Maximum Capacity / Filling Slot	No
Rolling Element	Ball Bearing
Snap Ring	No
Internal Special Features	No
Cage Material	Steel
Internal Clearance	C0-Medium
Inch - Metric	Metric
Long Description	17MM Bore; 35MM Outside Diameter; 8MM Outer Race Diameter; 2 Metal Shields; Ball Bearing; ABEC 1 ISO P0; No Filling Slot; No Snap Ring; No Internal Special Features
Category	Single Row Ball Bearing
UNSPSC	31171504
Harmonized Tariff Code	8482.10.50.68
Noun	Bearing
Keyword String	Ball
Manufacturer URL	http://www.skf.com
Manufacturer Item Number	16003-2Z
Weight / LBS	0.077
Outside Diameter	1.378 Inch 35 Millimeter
Outer Race Width	0.315 Inch 8 Millimeter
Bore	0.669 Inch 17 Millimeter
bore diameter:	17 mm
static load capacity:	3.25 kN
outside diameter:	35 mm



BEARING DRIVESHAFT, INC.

precision rating:	Not Rated
overall width:	8 mm
finish/coating:	Uncoated
bore type:	Round
cage material:	Steel
closure type:	Double Shielded
outer ring width:	8 mm
row type & fill slot:	Single Row Non-Fill Slot
fillet radius:	0.3 mm
internal clearance:	C0
maximum rpm:	22000 RPM
dynamic load capacity:	6.37 kN
series:	16
d_1	23 mm
D_2	31.2 mm
$r_{1,2}$ min.	0.3 mm
d_a min.	19 mm
d_a max.	22.6 mm
D_a max.	33 mm
r_a max.	0.3 mm
Basic dynamic load rating C	6.37 kN
Basic static load rating C_0	3.25 kN
Fatigue load limit P_u	0.137 kN
Calculation factor k_r	0.02
Calculation factor f_0	14
Mass bearing	0.032 kg