

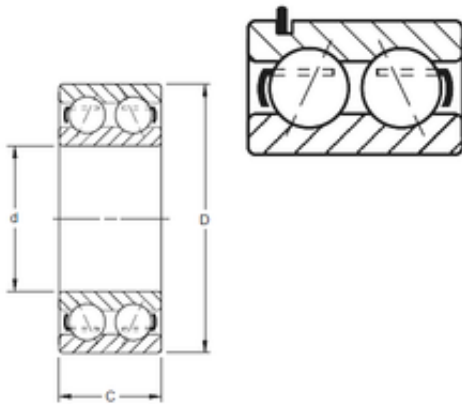

# BEARING DRIVESHAFT, INC.

## Timken 5304KG angular contact ball bearings



Bearing No. 5304KG

Size	20x52x22.25 mm
Bore Diameter	20 mm
Outer Diameter	52 mm
Width	22,25 mm
d	20 mm
D	52 mm
C	22,25 mm
Angle ( )	20 °
Weight	0,231 Kg
Basic dynamic load rating (C)	28,4 kN

5304KG Bearing 2D drawings and 3D CAD models